

REPLACEMENT PARTS MANUAL

WALL MOUNT GAS ELECTRICS

MODELS: WAG30B, WAG36B, WAG40B

Manual 2110-801

Revision G

Date 9-02-93

Supersedes 2-01-93

* GENERAL NOTES *

*Revised and/or additional pages may be issued from time to time.
*A complete and current manual consists of pages dated as shown in the following index.

** INDEX **

| <u>Page Description</u> | <u>Page</u> | <u>Date</u> | <u>Supersedes</u> |
|--------------------------------------|-------------|-------------|-------------------|
| Cabinet Components--Exploded View | 1 | 2-19-90 | 7-11-89 |
| " " --Usage List | 2 | 2-01-93 | 2-19-90 |
| Functional Components--Exploded View | 3 | 2-19-90 | 1-25-90 |
| " " --Usage List | 4 | 9-02-93 | 2-01-93 |
| Control Panel--Layout View | 5 | 7-11-89 | |
| " " --Usage List | 6 | 2-01-93 | 7-11-89 |

*** IMPORTANT ***

Contact the installing and/or local Bard distributor for all parts requirements. Make sure you have the complete model and serial number available from the unit rating plate.

BARD MANUFACTURING COMPANY

BRYAN, OHIO 43506

CABINET COMPONENTS

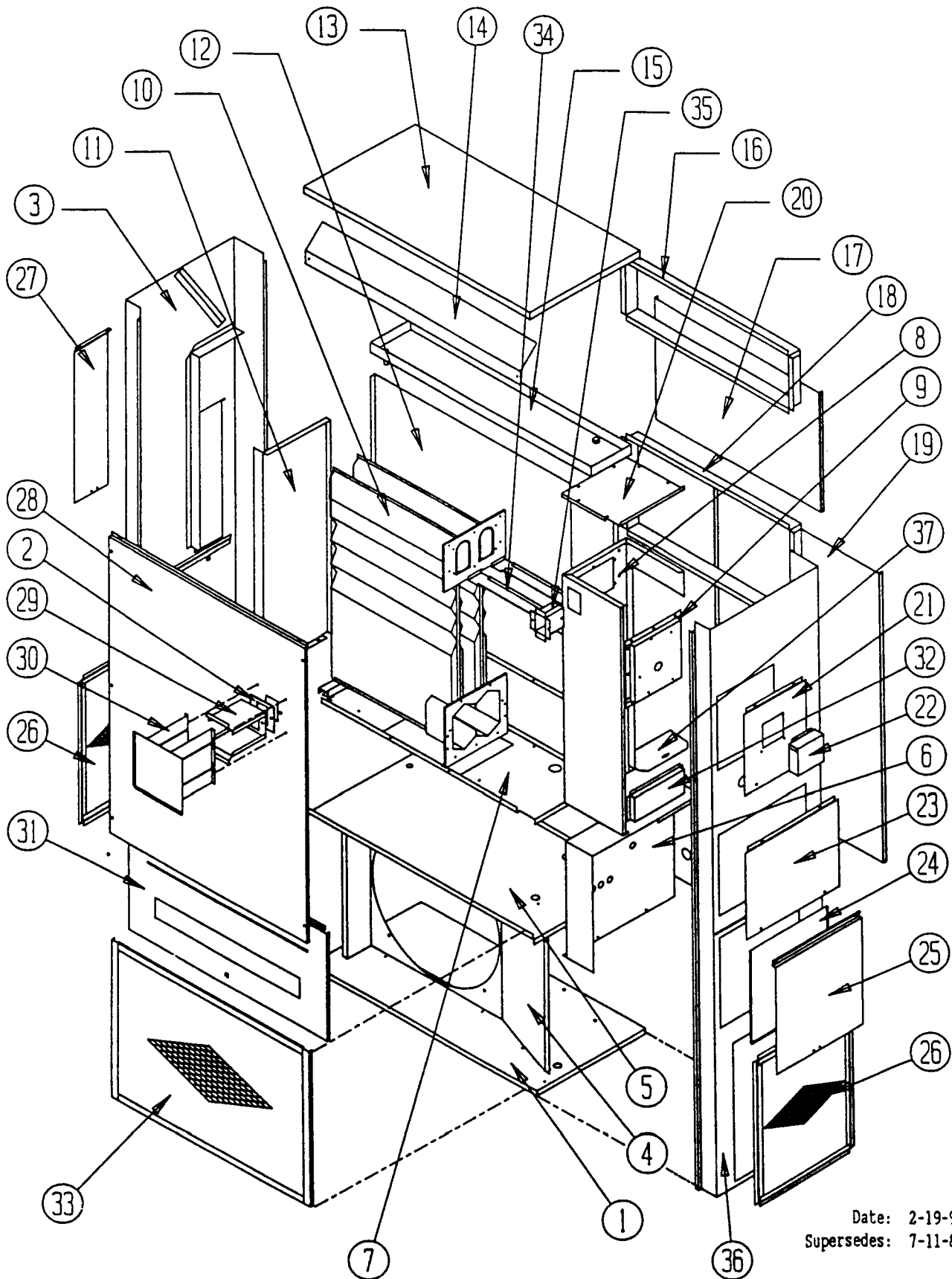

Date: 2-19-90
Supersedes: 7-11-89

CABINET COMPONENTS

| Dwg. No. | Part No. | Description | W A G 3 0 B A 5 4 C | W A G 3 6 B A 5 4 C | W A G 3 6 B B 5 4 C | W A G 3 6 B C 5 4 C | W A G 4 0 B A 5 4 C | W A G 4 0 B B 5 4 C | W A G 4 0 B C 5 4 C |
|----------|---------------|---|---|---|---|---|---|---|---|
| 1 | 127-216 | Lower Base | X | X | X | X | X | X | X |
| 2 | 1921-017 | Vent Term. Gasket | X | X | X | X | X | X | X |
| 3 | 501-179 | Left Side Assembly | X | X | X | X | X | X | X |
| 4 | 124-016 | Fan Shroud | X | X | X | X | X | X | X |
| 5 | 520-108 | Condenser Partition | X | X | X | X | X | X | X |
| 6 | Control Panel | (See Control Panel Assembly Drawing and Parts List) | | | | | | | |
| 7 | 127-143 | Blower Base | X | X | X | X | X | X | X |
| 8 | 520-110 | Heat Exchanger Partition | X | X | X | X | X | X | X |
| 9 | 913-0018 | Flue Collector Box Assembly | X | X | X | X | X | X | X |
| 10 | 171-152 | Heat Exchanger Assembly | X | X | X | X | X | X | X |
| 11 | 520-111 | Side Partition Assembly | X | X | X | X | X | X | X |
| 12 | 520-109 | Vertical Partition | X | X | X | X | X | X | X |
| 13 | 506-107 | Top | X | X | X | X | X | X | X |
| 14 | 134-096 | Air Baffle | X | X | X | X | X | X | X |
| 15 | 123-067 | Water Pan Assembly | X | X | X | X | X | X | X |
| 16 | 111-025 | Outlet Air Frame | X | X | X | X | X | X | X |
| 17 | 508-056 | Upper Back | X | X | X | X | X | X | X |
| 18 | 111-018 | Inlet Air Frame | X | X | X | X | X | X | X |
| 19 | 508-069 | Lower Back Assembly | X | X | X | X | X | X | X |
| 20 | 506-108 | Heat Exchanger Part. Top | X | X | X | X | X | X | X |
| 21 | 552-138 | Induced Blower Door | X | X | X | X | X | X | X |
| 22 | 134-097 | Induced Blower Hood | X | X | X | X | X | X | X |
| 23 | 152-139 | Burner Door | X | X | X | X | X | X | X |
| 24 | 132-096 | Inner Control Cover | X | X | X | | X | X | |
| 24 | 132-116 | Inner Control Cover | | | | X | | | X |
| 25 | 152-136 | Outer Control Cover | X | X | X | X | X | X | X |
| 26 | 119-020 | Side Condenser Grille | 2 | 2 | 2 | 2 | 2 | 2 | 2 |
| 27 | 552-137 | Filter Access | X | X | X | X | X | X | X |
| 28 | 514-062 | Upper Front | X | X | X | X | X | X | X |
| 29 | 168-029 | Inner Vent Term | X | X | X | X | X | X | X |
| 30 | 169-030 | Outer Vent Term | X | X | X | X | X | X | X |
| 31 | 514-080 | Lower Front | X | X | X | X | X | X | X |
| 32 | 168-003 | Secondary Air Baffle | X | X | X | X | X | X | X |
| 33 | 119-003 | Front Condenser Grille | X | X | X | X | X | X | X |
| 34 | 168-002 | Flue Baffle | 2 | 2 | 2 | 2 | 2 | 2 | 2 |
| 35 | 169-026 | Flue Transition | X | X | X | X | X | X | X |
| 36 | 501-178 | Right Side Assembly | X | X | X | X | X | X | X |
| 37 | 140-164 | Switch Support | X | X | X | X | X | X | X |

112-009 Side Bracket 2
 112-006 Bottom Bracket 1

Date: 01-13-93
 Supersedes: 2-19-90

FUNCTIONAL COMPONENTS

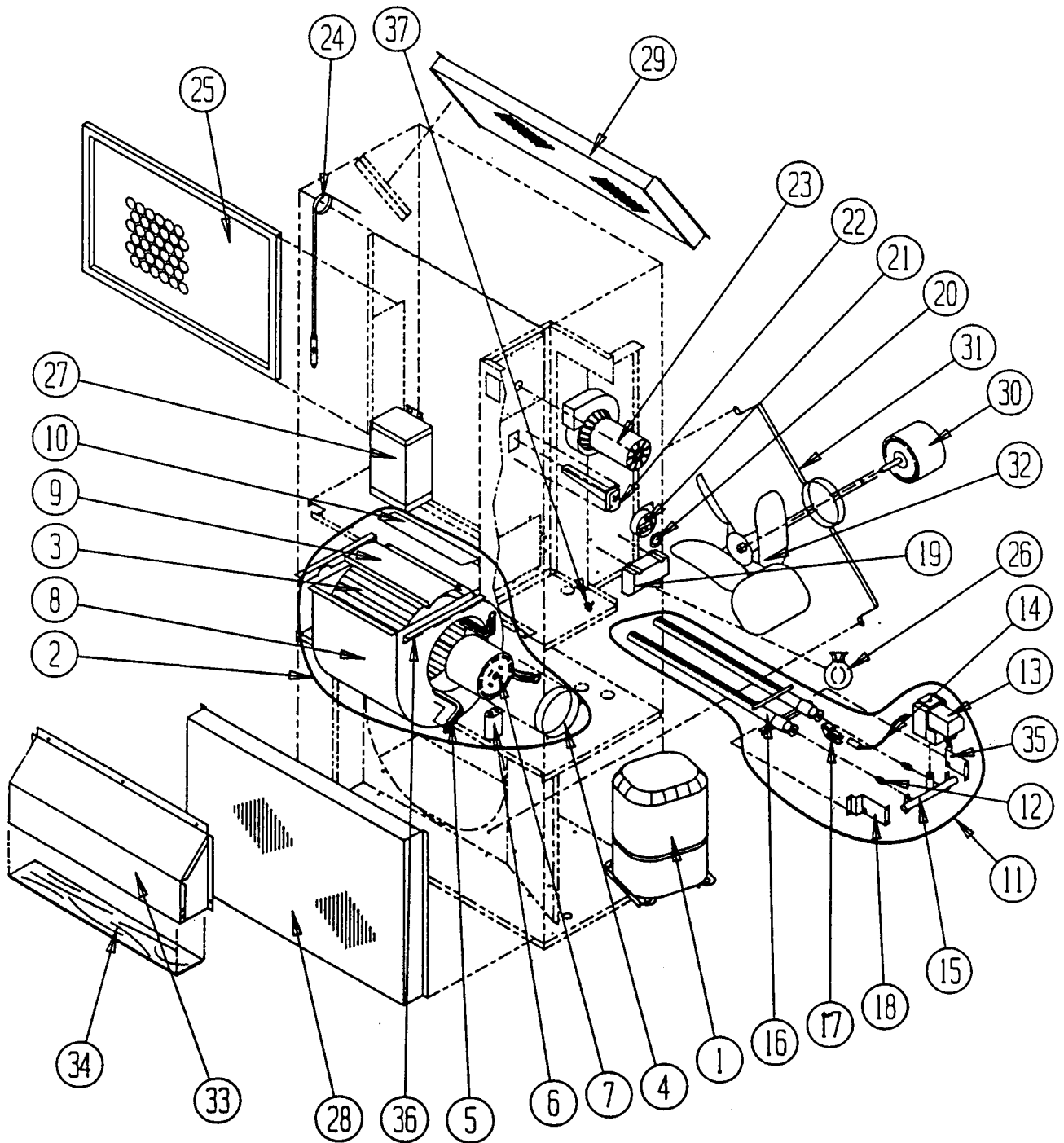

Date: 2-19-90
Supersedes: 1-25-90

FUNCTIONAL COMPONENTS

| Dwg. No. | Part No. | Description | W | W | W | W | W | W | W |
|----------|------------|---------------------------------|---|---|---|---|---|---|---|
| | | | A | A | A | A | A | A | A |
| | | | G | G | G | G | G | G | G |
| | | | 3 | 3 | 3 | 3 | 4 | 4 | 4 |
| | | | 0 | 6 | 6 | 6 | 0 | 0 | 0 |
| | | | B | B | B | B | B | B | B |
| | | | A | A | B | C | A | B | C |
| | | | 5 | 5 | 5 | 5 | 5 | 5 | 5 |
| | | | 4 | 4 | 4 | 4 | 4 | 4 | 4 |
| | | | C | C | C | C | C | C | C |
| 1 | 8000-132 | Compressor | X | | | | | | |
| 1 | 8000-125 | Compressor | | X | | | | | |
| 1 | 8000-133 | Compressor | | | X | | | | |
| 1 | 8000-134 | Compressor | | | | X | | | |
| 1 | 8000-126 | Compressor | | | | | X | | |
| 1 | 8000-127 | Compressor | | | | | | X | |
| 1 | 8000-128 | Compressor | | | | | | | X |
| 2 | 900-123 | Blower Assembly (Complete) | X | X | X | X | X | X | X |
| 3 | 5152-059 | Blower Wheel | X | X | X | X | X | X | X |
| 4 | 8200-033 | Motor Mount Band | X | X | X | X | X | X | X |
| 5 | 8200-036 | Motor Mount Arm | 3 | 3 | 3 | 3 | 3 | 3 | 3 |
| 6 | 8552-002 | Capacitor | X | X | X | X | X | X | X |
| 7 | 8105-031 | Blower Motor | X | X | X | X | X | X | X |
| 8 | 151-083 | Blower Housing | X | X | X | X | X | X | X |
| 9 | 144-129 | Diffuser | X | X | X | X | X | X | X |
| 10 | 104-752 | Blower Seal | X | X | X | X | X | X | X |
| 11 | 901-0072 | Burner Assembly (Complete) | X | X | X | X | X | X | X |
| 12 | 9010-043 | High Rate Orifice (Nat. #36) | 2 | 2 | 2 | 2 | 2 | 2 | 2 |
| 13 | 5651-080 | Gas Valve | X | X | X | X | X | X | X |
| 14 | 8600-010 | Ignition Wire | X | X | X | X | X | X | X |
| 15 | 5818-023 | Burner Manifold | X | X | X | X | X | X | X |
| 16 | 9010-036 | Burner (2 Cell) | X | X | X | X | X | X | X |
| 17 | 8620-038 | Pilot Burner | X | X | X | X | X | X | X |
| 18 | 112Y095 | Left Manifold Bracket | 2 | 2 | 2 | 2 | 2 | 2 | 2 |
| 19 | 5651-093 | Ignition Module | X | X | X | X | X | X | X |
| 20 | 5451-015 | Rubber Grommet | X | X | X | X | X | X | X |
| 21 | 8406-052 | Pressure Switch | X | X | X | X | X | X | X |
| 22 | 8402-052 | Limit Control | X | X | X | X | X | X | X |
| 23 | 8109-002 | Induced Draft Motor | X | X | X | X | X | X | X |
| 24 | 800-0128 | Capillary Assembly | X | | | | | | |
| 24 | 800-0129 | Capillary Assembly | | X | X | X | | | |
| 24 | 800-0130 | Capillary Assembly | | | | | X | X | X |
| 25 | 7004-016 | Air Filter | X | X | X | X | X | X | X |
| 26 | 400-0027 | Low Rate Orifice Kit (Nat. #40) | X | X | X | X | X | X | X |
| 27 | 8407-003 | 460V Transformer | | | | X | | | X |
| 28 | 5051-035 | Condenser Coil | X | | | | | | |
| 28 | 5051-054 | Condenser Coil | | X | X | X | | | |
| 28 | 5051-050 | Condenser Coil | | | | | X | X | X |
| 29 | 5060-037 | Evaporator Coil | X | | | | | | |
| 29 | 5060-050 | Evaporator Coil | | X | X | X | X | X | X |
| 30 | 8103-019 | Condenser Motor | X | | | | | | |
| 30 | 8105-034 | Condenser Motor | | X | X | X | X | X | X |
| 31 | 8200-037 | Fan Motor Mount | X | X | X | X | X | X | X |
| 32 | 5151-038 | Fan Blade | X | | | | | | |
| 32 | 5151-028 | Fan Blade | | X | X | X | X | X | X |
| 33 | S 913-0068 | Fresh Air Damper Assembly | X | X | X | X | X | X | X |
| 34 | 7003-036 | Air Filter | X | X | X | X | X | X | X |
| 35 | 112X095 | Right Manifold Bracket | X | X | X | X | X | X | X |
| 36 | 104-791 | Blower Angles | 2 | 2 | 2 | 2 | 2 | 2 | 2 |
| 37 | 8406-046 | Flame Rollout Switch | X | X | X | X | X | X | X |
| | 8620-040 | Pilot Gas Tube With Fittings | X | X | X | X | X | X | X |
| | 5153-030 | Tee/Orifice Assembly | X | X | X | X | X | X | X |

1921-039

GASKET ~~ASST~~

CONTROL PANEL

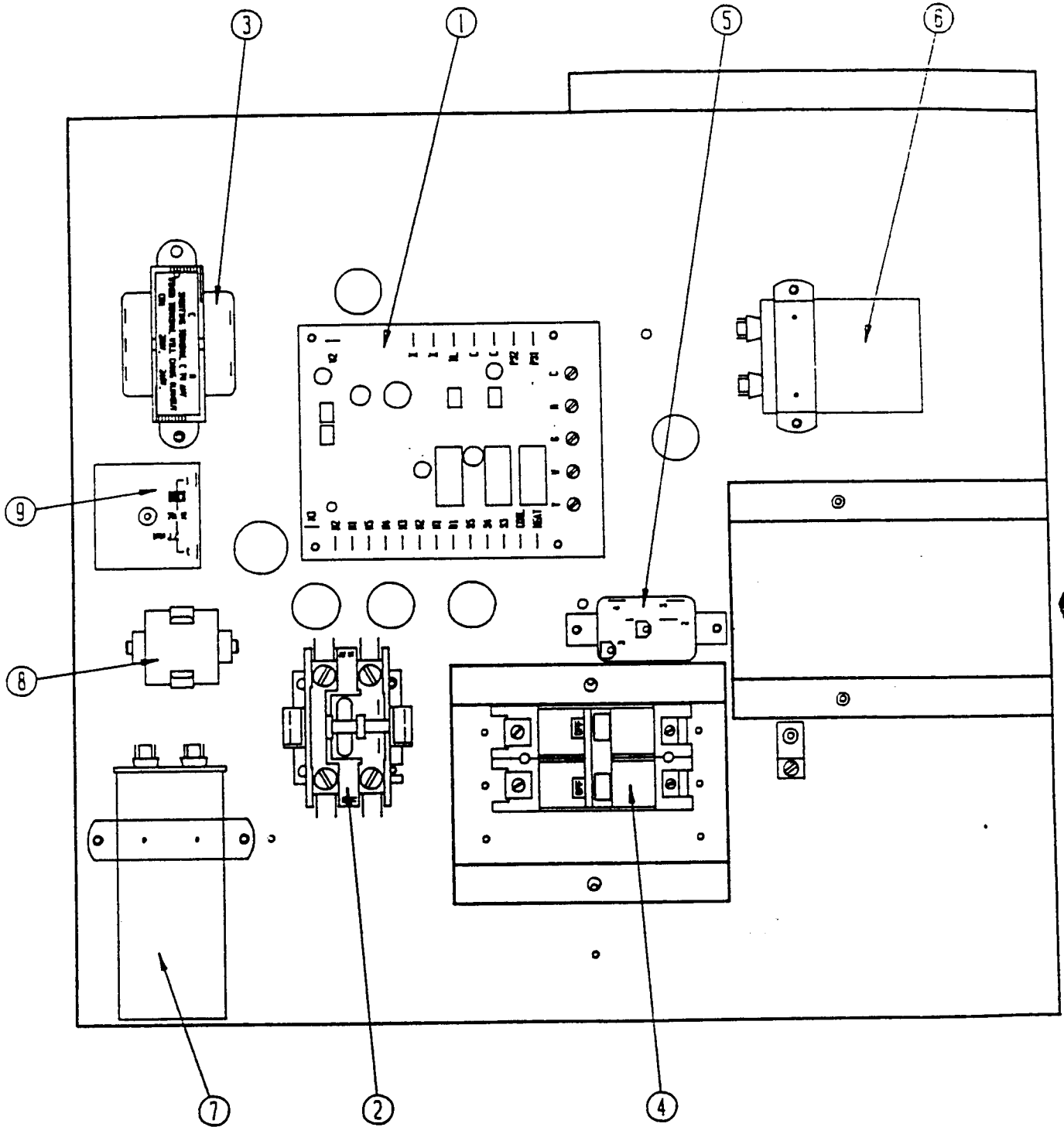

Date: 7-11-89
Supersedes:

CONTROL PANEL

| Dwg. No. | Part No. | Description | W | W | W | W | W | W | W |
|----------|----------|-----------------------------|---|---|---|---|---|---|---------------------------|
| | | | A | A | A | A | A | A | A |
| | | | G | G | G | G | G | G | G |
| | | | 3 | 3 | 3 | 3 | 4 | 4 | 4 |
| | | | B | B | B | B | B | B | B |
| | | | | | | | | | |
| | | | A | A | B | C | A | B | C |
| | | | 5 | 5 | 5 | 5 | 5 | 5 | 5 |
| | | | 4 | 4 | 4 | 4 | 4 | 4 | 4 |
| | | | C | C | C | C | C | C | C |
| 1 | 8201-053 | Blower Control | X | X | X | X | X | X | X |
| 2 | 8401-007 | Contacto Coil | X | X | | | X | | |
| 2 | 8401-002 | Contacto Coil | | | X | X | | X | X |
| 3 | 8407-034 | Transformer | X | X | X | X | X | X | X |
| 4 | 8615-038 | Circuit Breaker | X | | | | | | |
| 4 | 8615-055 | Circuit Breaker | | X | | | | | |
| 4 | 8615-052 | Circuit Breaker | | | X | | | | |
| 4 | 8615-040 | Circuit Breaker | | | | | X | | |
| 4 | 8615-042 | Circuit Breaker | | | | | | X | |
| 4 | 8615-053 | Pull Disconnect | | | | X | | | X |
| 5 | 8201-008 | Outdoor Fan Relay | | | | X | | | X |
| 6 | 8552-002 | Fan Capacitor | X | | | | | | |
| 6 | 8552-005 | Fan Capacitor | | | X | X | | X | X |
| 7 | 8552-048 | Compressor/Fan Capacitor | X | | | | | | |
| 7 | 8552-055 | Compressor/Fan Capacitor | | X | | | X | | |
| 8 | | Low Voltage Kit | | | | | | | <----Field Installed----> |
| 9 | | Compressor Anti Cycle Relay | | | | | | | <----Field Installed----> |
| | 4085-111 | Wiring Diagram | X | X | | | X | | |
| | 4085-211 | Wiring Diagram | | | X | | | X | |
| | 4085-311 | Wiring Diagram | | | | X | | | X |

Date: 01-13-93
Supersedes: 7-11-89