

REPLACEMENT PARTS MANUAL

PACKAGED AIR CONDITIONER MODEL RPMA30A, RPMA36A

Manual 2110-205

Revision --

Date 8-17-89

Supersedes

* GENERAL NOTES *

*Revised and/or additional pages may be issued from time to time.
*A complete and current manual consists of pages dated as shown in the following index.

** INDEX **

<u>Page Description</u>	<u>Page</u>	<u>Date</u>	<u>Supersedes</u>
Cabinet Components--Exploded View	1	8-17-89	
" " --Usage List	2	8-17-89	
Functional Components--Exploded View	3	8-17-89	
" " --Usage List	4	8-17-89	
Control Panel--Layout	5	8-17-89	
" " --Usage	6	8-17-89	

*** IMPORTANT ***

Contact the installing and/or local Bard distributor for all parts requirements. Make sure you have the complete model and serial number available from the unit rating plate.

BARD MANUFACTURING COMPANY

BRYAN, OHIO 43506

CABINET COMPONENTS

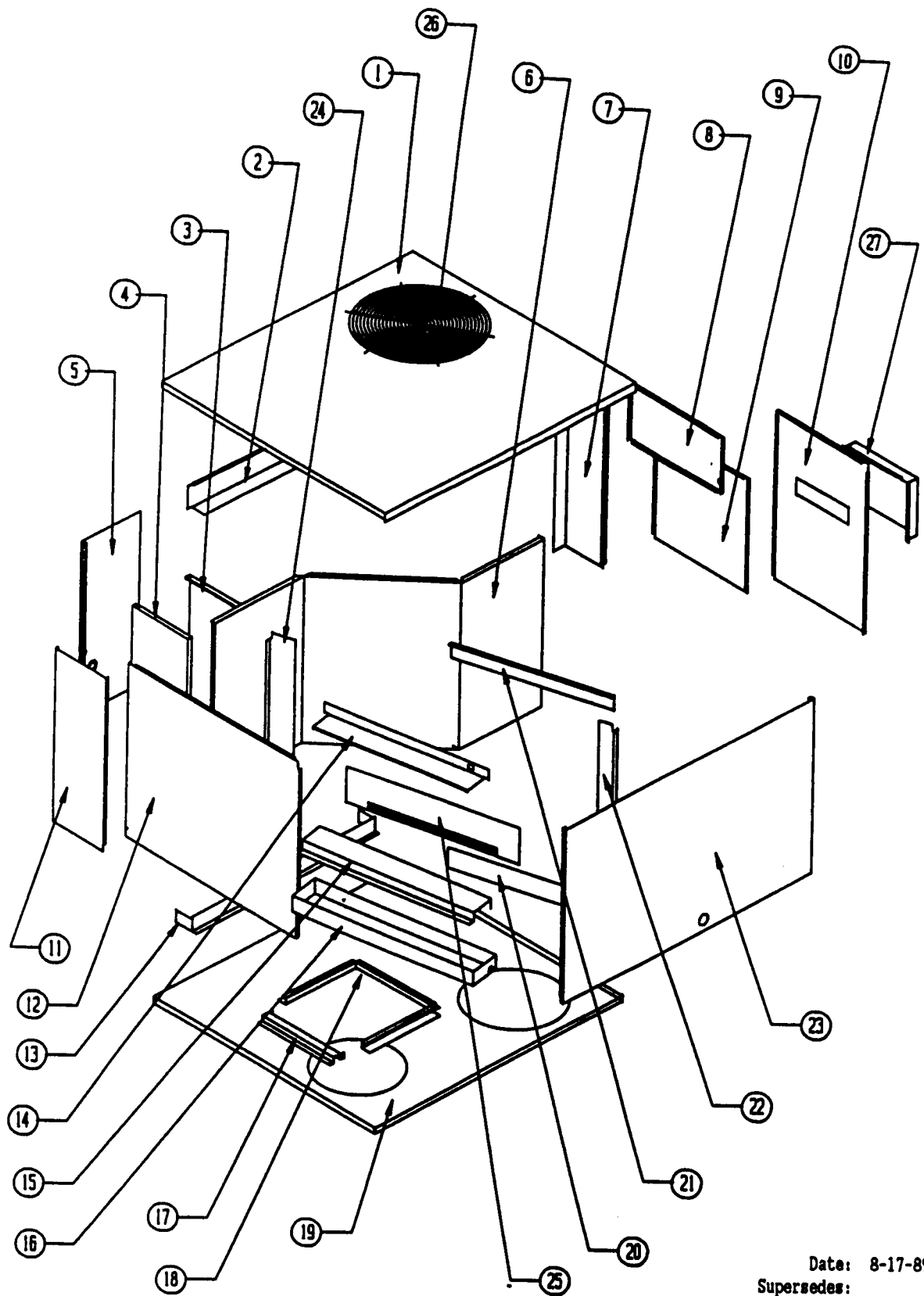

Date: 8-17-89
Supersedes:

CABINET COMPONENTS

Dwg. No.	Part No.	Description	U S A G E
1	507-014	Top	X
2	136-020	Condenser Fill Plate (RPMA's only)	X
2	136-021	Condenser Fill Plate (RPMH's only)	X
3	134-057	Rain Shield	X
4	Cntrl Pnl Assembly	See Control Panel Assembly Drawing and Parts List	X
5	149-047	Control Panel Corner	X
6	521-081	Partition	X
7	149-051	Condenser Corner	X
8	152-109	Fan Service Door	X
9	152-110	Compressor Service Door	X
10	553-010	Filter Access Door	X
11	132-049	Control Panel Cover	X
12	553-100	Blower Service Door	X
13	140-041	Condenser Coil Support (RPMH's only)	X
14	136-029	Top Evap. Fill Plate	X
15	140-040	Evap. Coil Base	X
16	123-011	Drain Pan	X
17	144-095	Blower Slide End	X
18	144-094	Blower Slide	X
19	527-014	Base	X
20	137-027	Lower Filter Fill	X
21	136-022	Upper Filter Fill	X
22	141-043	Filter Support	X
23	514-010	Front	X
24	141-042	Evap. Coil Support	X
25	137-028	Evap. Coil Fill (RPMA's only)	X
26	7051-014	Fan Grille	X
27	962001	Fresh Air Damper	X

Date: 8-17-89
Supersedes:

FUNCTIONAL COMPONENTS

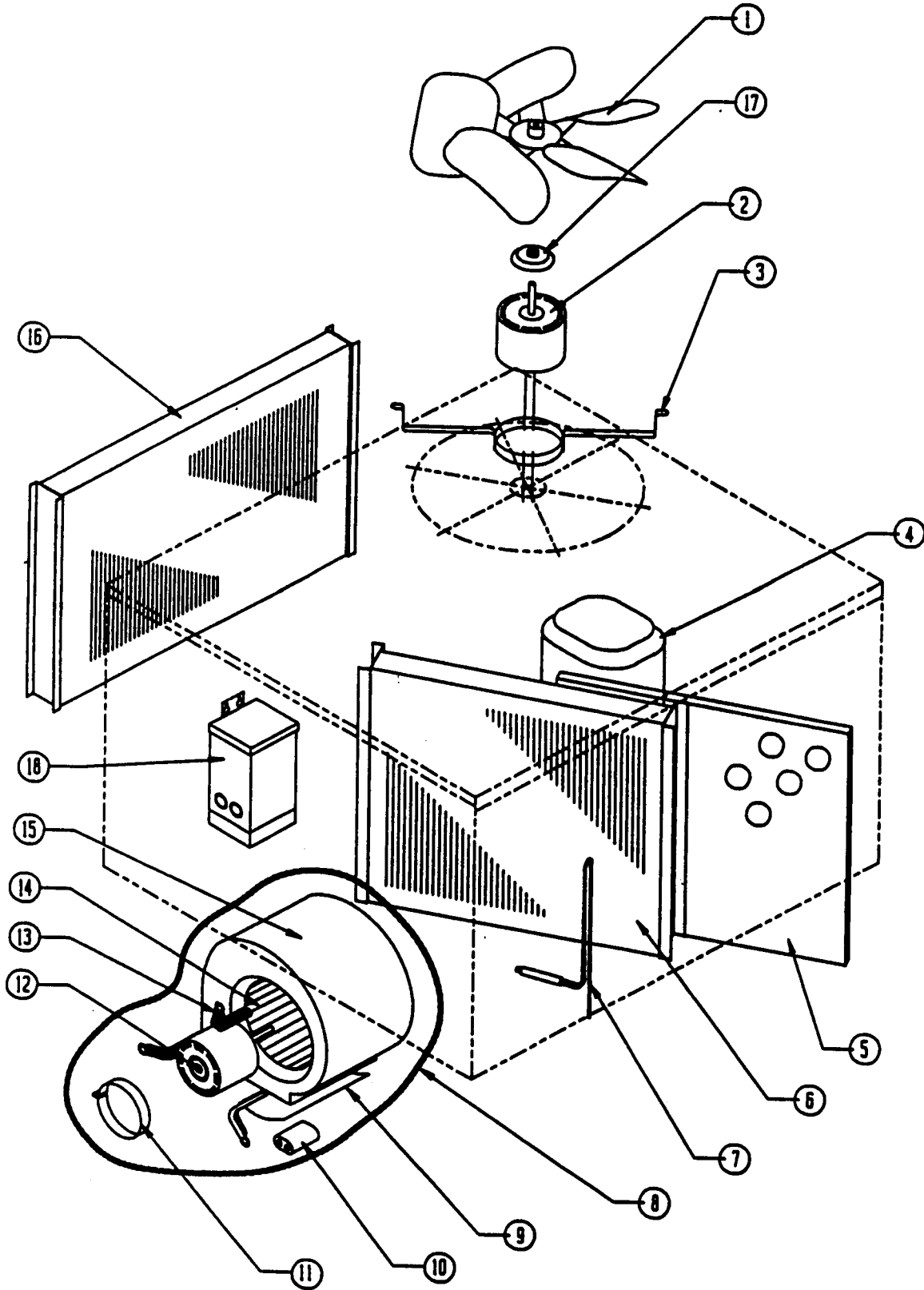

Date: 8-17-89
Supersedes:

FUNCTIONAL COMPONENTS

Dwg. No.	Part No.	Description	R	R	R	R	R	R
			P	P	P	P	P	P
			M	M	M	M	M	M
			A	A	A	A	A	A
			3	3	3	3	3	3
			0	0	0	6	6	6
			A	A	A	A	A	A
				B	C		B	C
1	5151-031	Fan Blade	X	X	X	X	X	X
2	8103-013	Motor	X	X	X	X	X	X
3	8200-022	Motor Mount	X	X	X	X	X	X
4	8000-086	Compressor	X					
4	8000-053	Compressor		X				
4	8000-054	Compressor			X			
4	8000-055	Compressor				X		
4	8000-056	Compressor					X	
4	8000-057	Compressor						X
5	7004-015	Filter 24 x 24 x 1	X	X	X	X	X	X
6	5060-012	Evaporator Coil	X	X	X			
6	5060-022	Evaporator Coil				X	X	X
7	800-0024	Capillary Tube Assembly	X	X	X			
7	800-0023	Capillary Tube Assembly				X	X	X
8	900-130	Complete Blower Assembly	X	X	X			
8	900-131	Complete Blower Assembly				X	X	X
9	144-126	Diffuser	X	X	X	X	X	X
10	8552-019	Capacitor 5/440	X	X	X	X	X	X
11	8200-033	Motor Mount Band	X	X	X	X	X	X
12	8105-010	Motor	X	X	X	X	X	X
13	8200-034	Motor Mount Arm	3	3	3	3	3	3
14	5152-005	Blower Wheel	X	X	X			
14	5152-010	Blower Wheel				X	X	X
15	151-080	Blower Housing	X	X	X	X	X	X
16	5051-035	Condenser Coil	X	X	X	X	X	X
17	5153-022	Rain Shield	X	X	X	X	X	X
18	8407-003	Transformer			X			X

Date: 8-17-89
Supersedes:

CONTROL PANEL

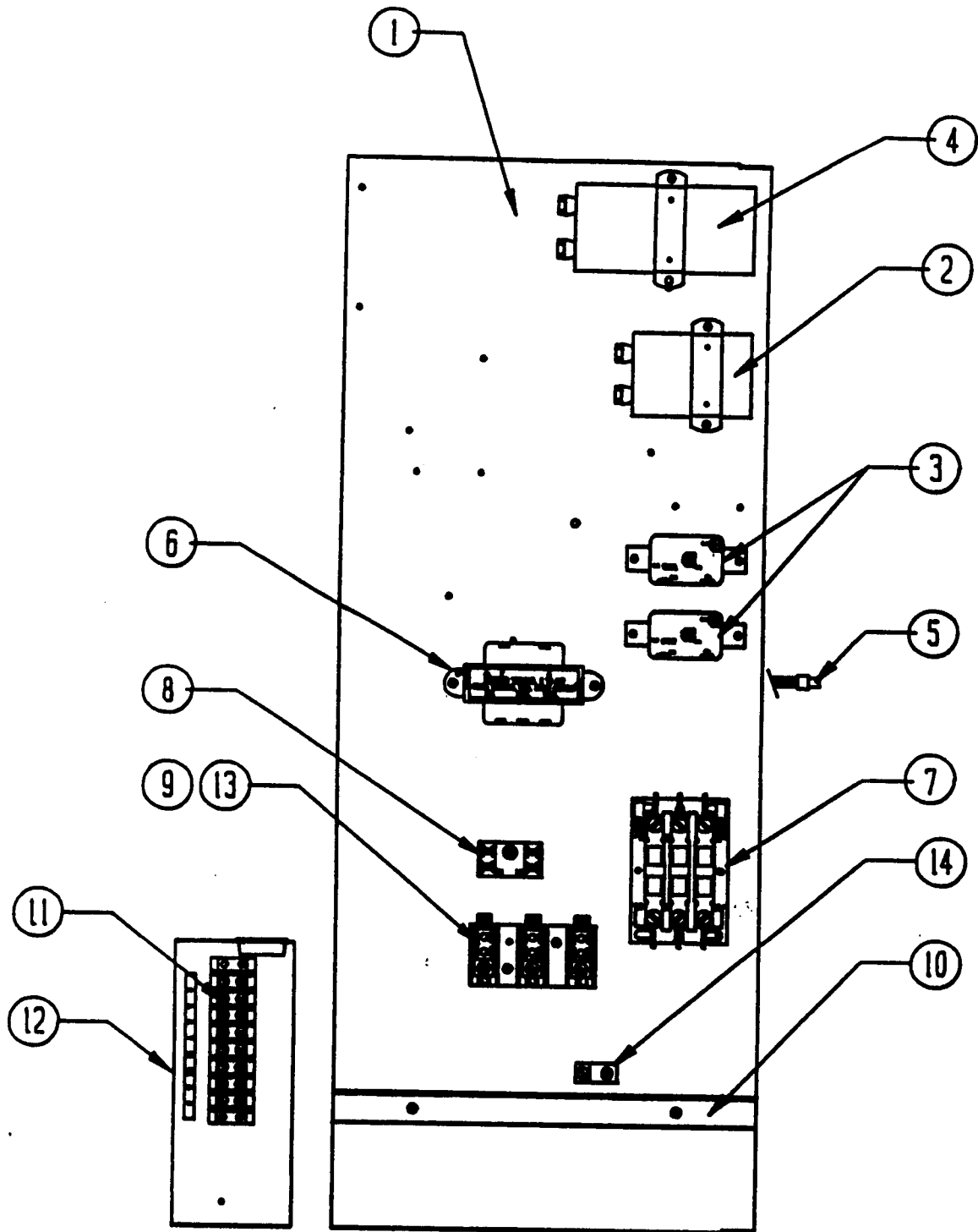

Date: 8-17-89
Supersedes:

CONTROL PANEL

Dwg. No.	Part No.	Description	R	R	R	R	R	R
			P	P	P	P	P	P
			M	M	M	M	M	M
			A	A	A	A	A	A
			3	3	3	6	6	6
			O	O	O	A	A	A
			A	A	A	A	A	A
				B	C		B	C
1	116-089	Control Panel	X	X	X	X	X	X
2	8552-002	Capacitor 5/370	X	X	X	X	X	X
3	8201-008	Blower Relay	X	X	X	X	X	X
4	8552-032	Capacitor 35/370				X		
4	8552-035	Capacitor 40/370	X					
5	3000-907	Wire Assembly	X	X	X	X	X	X
6	8407-034	Transformer	X	X	X	X	X	X
7	8401-007	Contactor	X			X		
7	8401-002	Contactor		X	X		X	X
8	8607-017	Terminal Block			X			X
9	8607-013	Terminal Block	X			X		
9	8607-014	Terminal Block		X	X		X	X
10	116-091	Partition	X	X	X	X	X	X
11	8607-006	Terminal Strip	X	X	X	X	X	X
12	116-090	Low Voltage Box	X	X	X	X	X	X
13	8607-015	Phenolic Insulator			X			X
14	8611-006	Ground Terminal	X	X	X	X	X	X
	4072-110	Wiring Diagram	X			X		
	4072-210	Wiring Diagram		X			X	
	4072-310	Wiring Diagram			X			X

Date: 8-17-89
Supersedes: