

REPLACEMENT PARTS MANUAL

SPLIT HEAT PUMPS MODELS 30HPQ6, 36HPQ7

Manual 2110-052

Revision B

Date 2-15-91

Supersedes 8-15-90

* GENERAL NOTES *

*Revised and/or additional pages may be issued from time to time.
*A complete and current manual consists of pages dated as shown in the following index.

** INDEX **

<u>Page Description</u>	<u>Page</u>	<u>Date</u>	<u>Supersedes</u>
Functional and Cabinet Components--Exploded View	1	7-11-89	
" " " --Usage List	2	2-15-91	8-15-90
Control Panel--Layout	3	7-11-89	
" " --Usage List	4	7-11-89	

*** IMPORTANT ***

Contact the installing and/or local Bard distributor for all parts requirements. Make sure you have the complete model and serial number available from the unit rating plate.

FUNCTIONAL AND CABINET COMPONENTS

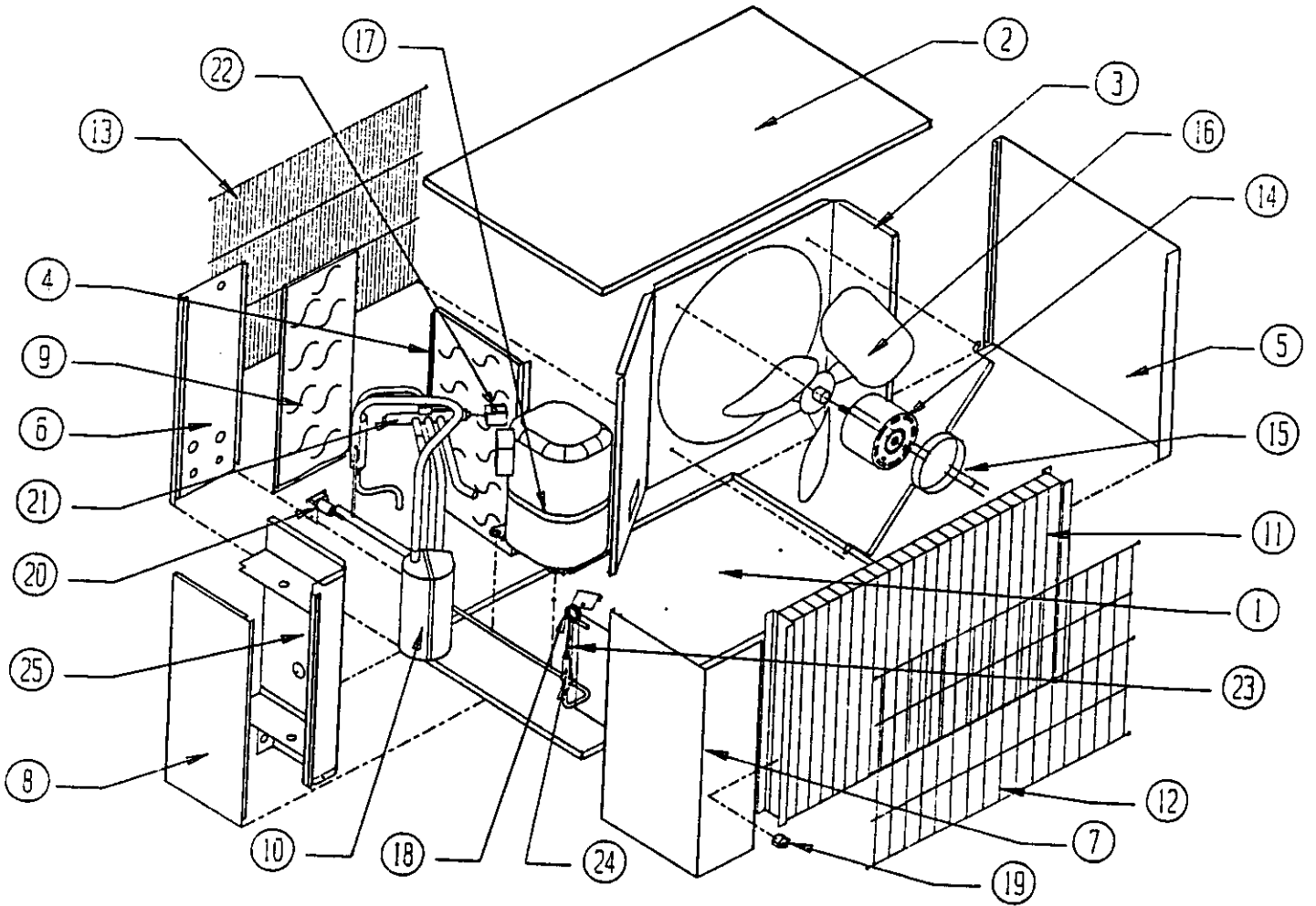

Date: 7-11-89
Supersedes:

FUNCTIONAL AND CABINET COMPONENTS

Dwg. No.	Part No.	Description	3 0 H P Q 6	3 0 H P Q 6 B	3 0 H P Q 6 C	3 0 H P Q 6 D	3 6 H P Q 7	3 6 H P Q 7 B	3 6 H P Q 7 C	3 6 H P Q 7 D	3 6 H P Q 7 E	3 6 H P Q 7 F
1	127-019	Base	X	X	X	X	X	X	X	X	X	X
2	507-018	Top	X	X	X	X	X	X	X	X	X	X
3	124-008	Fan Shroud	X	X	X	X	X	X	X	X	X	X
4	520-020	Compressor Partition	X	X	X	X	X	X	X	X	X	X
5	100-124	Side Right	X	X	X	X	X	X	X	X	X	X
6	148-032	Corner--Control Box	X	X	X	X	X	X	X	X	X	X
7	548-042	Corner--Condenser	X	X	X	X	X	X	X	X	X	X
8	132-021	Control Panel Cover	X	X	X	X	X	X	X	X	X	X
9	552-017	Door--Compressor Access	X	X	X	X	X	X	X	X	X	X
10	5202-016	Accumulator	X	X	X	X	X	X	X	X	X	X
11	5051-003	Condenser Coil	X	X	X	X						
11	5051-053	Condenser Coil					X	X	X	X	X	X
12	7051-001	Condenser Grille	X	X	X	X	X	X	X	X	X	X
13	7051-003	Inlet Grille	X	X	X	X	X	X	X	X	X	X
14	8103-019	Motor--Fan 1/5	X	X		X	X			X	X	X
14	8103-014	Motor--Fan 1/5 460V			X				X			
15	8200-001	Motor Mount--Fan	X	X	X	X	X	X	X	X	X	X
16	5151-007	Fan Blade	X	X	X	X	X	X	X	X	X	X
17	8000-103	Compressor AM5532F	X									
17	8000-053	Compressor CRG3-0250-TF5		X								
17	8000-054	Compressor CRG3-0250-TFD			X							
17	8000-087	Compressor H23A383ABCA					X					
17	8000-088	Compressor AV145RT						X			X	
17	8000-089	Compressor AV145TT							X			X
17	8000-038	Compressor				X						
17	8000-039	Compressor								X		
18	5811-020	Capillary Tube--Heat	1	1	1	1						
18	5811-012	Capillary Tube--Heat					2	2	2	2	2	2
19	8408-018	Defrost Thermostat	X	X	X	X	X	X	X	X	X	X
20	8406-010	High Pressure Switch	X	X	X	X	X	X	X	X	X	X
21	5650-013	Reversing Valve	X	X	X	X						
21	5650-006	Reversing Valve					X	X	X	X	X	X
22	5650-008	Solenoid Coil	X	X	X	X	X	X	X	X	X	X
23	5651-036	Check Valve	X	X	X	X	X	X	X	X	X	X
24	5210-002	Strainer	X	X	X	X						
24	5210-004	Strainer					X	X	X	X	X	X
25	*	Control Panel *See control panel drawing	X	X	X	X	X	X	X	X	X	X
	5625-063	Restrictor w/.063" Orifice	X	X	X	X	X	X	X	X	X	X

Date: 2-15-91
Supersedes: 8-15-90

